



Layout Deck



Asymmetrical cockpit with lots of space to port. By lowering the table the seating area converts into a huge sun bathing area.

2-Cabin Version

3-Cabin Version

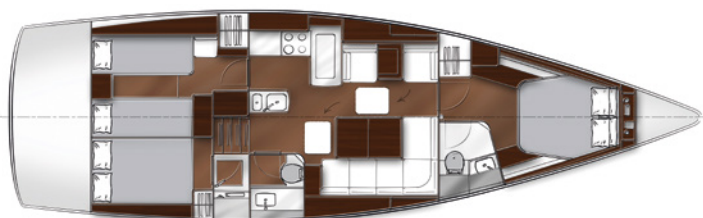

Technical data

Length overall	13,99 m
Length hull	13,70 m
Length waterline	12,83 m
Beam overall	4,19 m
Draught standard cast iron keel (approx.)	2,14 m
Draught option cast iron keel as shallow keel	1,70 m
Unladen weight (approx.)	12.300 kg
Ballast (approx.)	3.450 kg
Engine, Volvo-Penta with Saildrive	D2-55
Engine power	41 kW/55 hp
Fuel tank (approx.)	210 l
Water tank (approx.)	580 l
Height in saloon (approx.)	2,00 m
Mainsail and furling jib, standard (approx.)	103 m²

Height of mast above water line, option Intracoastal Waterway	19,36 m/(63,5 ft)
Cabins, standard version	2
Bathrooms, standard version	1
Berths, standard version	4
Showers, standard version	1
Height of mast above water line (approx.)	20,10 m

Base price off shipyard **187.500,00 EUR**
(excl. VAT)

Possible versions	
Cabins	2/3
Berths	4/6
Bathrooms	1/2



YOUR BENEFIT: THE BAVARIA ENHANCED STANDARD

SAILING EQUIPMENT

- Furling- Genua with UV-Protection
- Self-tailing Winches (4 pieces)
- Backstay adjuster
- Electric windless

EXTERIOR

- Bathing platform manual lowerable
- Teak on cockpit seats
- Cockpit table
- Rodkick

INTERIOR

- Mosquito screen on hatches
- Electric Fridge
- Cook top with oven

SYSTEMS

- 3 AGM boardbatteries, each 92 Ah
- Shore power supply incl. charger
- Shower in Cockpit and Bathrooms
- Water heater 40 liter

STANDARD EQUIPMENT*

Exterior

Hull

Grey coloured stripe on hull, Hull colour white, 6 hull windows (fixed)

Rudder / Keel

Cast iron keel as deep keel, Emergency tiller

Steering pedestal

2 steering pedestal with compass and steering wheel covered with leather, Helmsman seats

Instrument console in steering pedestal

Deck

Cockpit floor, Side deck and coach roof with anti slip structure

Electric Windless, 6 aluminium cleats, Deck ventilator

Coaming for sprayhood, Twin mainsheet system

Pulpit, pushpit, Guardrail, Guardrail opening on both sides

Bow fitting with anchor roller

Bathing platform

Bathing platform manually lowerable with teak

Bathing ladder stainless steel

Cockpitshower for warm and cold water

Hatches and side windows

7 openable hatches

3 openable port lights

Cockpit

Teak on cockpit seats

Cockpit table, manually height adjustable and foldable

Gasbox "USA" for 2 x 11 lb bottles, self draining

Standing / running gear

Mainsail in dacron, offshore-quality, for sport rig

Furling jib in dacron, offshore-quality, UV-protection

Sport rig

Backstay adjuster, mechanical, Windex, Rodkick

Winches

2 winch handles

1 x Lewmar Evo aluminium winch on coach roof, 2-gear, self-tailing (45)

2 x Lewmar Evo aluminium winches in aft cockpit, 2-gear, self-tailing (45)

Interior

Cabins

2 cabins

Locker in foreship and aft cabin

Mattresses fabric "Living"

Furniture panels covered with fabric

Upholstery "Comfort" with relax edges

Bathroom

Manuel ø 38 cm with holding tank, disposal via seacock and deck suction for each toilet

Shower in shower cabin

Saloon

Interior in solid wood and veneer,

standard in sipo

Floor chestnut

Blinds on hatches

Mosquito screen on hatches in saloon and foreship

saloon table, fixed

saloon with settee

Standard upholstery

Sideboards, shelves and cabinets

Artificial leather covered headlining panels

Handrails on ceiling (stainless steel)

Handholds at companion way

Storage space with drawers and flaps

Companion way door as bulkhead in perspex

Navigation corner

Chart table, height adjustable with instrument console

and chart table seat

Galley

2 flame gas cook top with oven

Fridge and freezer combination 172 l with compressor, subdivided, openable from top and front

Double stainless steel sink

Dish dryer above kitchen island

3 Fire extinguishers

Systems

Fresh water

Electric pressurised water pump with filter
Warm water heater 40 l operated via engine-cooling circuit and shore power

Bilge pump

Manual bilge pump

Electric bilge pump

Engine

Two circuit cooling with seawater filter

Engine hour meter and rev meter

Voltmeter, Fuel indicator

Electric system

2 separated battery circuits for engine and service

3 Board batteries, each 92Ah

Battery charger, 40 A (3-channel)

Shore power 230 V (1 x 230 V AC-outlet on switch board, shore power 110 V for surcharge)

Main power supply with circuit breaker and control lamps

AC-outlet package 230 V

12 V outlet with 2 USB connections at switch board

Navigation

LED navigation lights and anchor light

Certification

CE-Certification category A

CE-Certification category B

GL CE-Yacht certification

* INKLUSIVE ENHANCED STANDARDS