

CRUISER 46 / *Style*



3-Cabin Version



4-Cabin Version

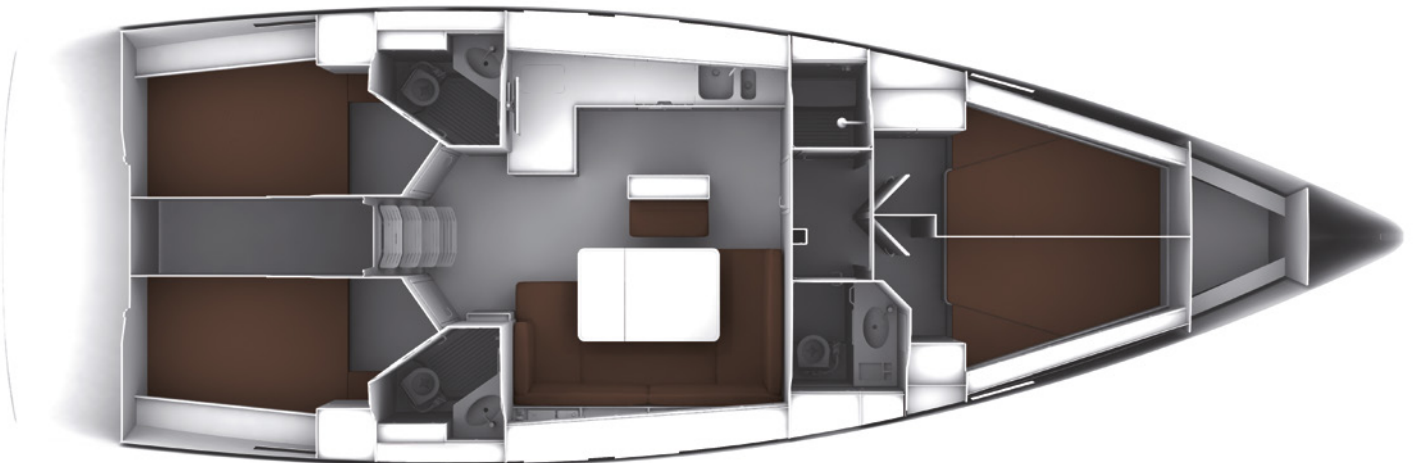

Technical data

Length overall	14,27 m	Height of mast above water line (approx.)	20,75 m
Length hull	13,60 m	Height of mast above water line, option Intracoastal Waterway	19,36 m / (63,5 ft)
Length waterline	12,94 m	Cabins, standardversion	3
Beam overall	4,35 m	Bathrooms, standard version	3
Draught standard cast iron keel (approx.)	2,10 m	Berths, standard version	6
Draught option cast iron keel as shallow keel (approx.)	1,73 m	Showers, standard version	2
Unladen weight (approx.)	12.600 kg	Separate shower cabin	1
Ballast (approx.)	3.490 kg		
Engine, Volvo Penta with Saildrive	D2-55	Base price off shipyard	(excl. VAT)
Engine power	41 kW/55 hp	CRUISER 46	177.500,00 EUR
Fuel tank (approx.)	210 l	CRUISER 46 <i>Style</i>	184.400,00 EUR
Water tank (approx.)	360 l	Possible versions	
Height in saloon (approx.)	2,05 m	Cabins	3/4
Mainsail and furling jib, standard (approx.)	108 m²	Berths	6/8



YOUR BENEFIT: THE BAVARIA ENHANCED STANDARD

SAILING EQUIPMENT

- Rollreff-Genua with UV-Protection
- Self-tailing Winches (4 pieces)
- Backstay adjuster
- Rodkick with gas spring

EXTERIOR

- Bathing platform manual lowerable
- Electric windless
- Teak on cockpit seats
- Cockpit table with foldable wings

INTERIOR

- Mosquito screen on hatches
- Electric Fridge
- Cook top with oven

SYSTEMS

- 3 AGM boardbatteries, each 92 Ah
- Shore power supply incl. charger
- Shower in Cockpit and Bathrooms
- Hot water 40 liter

PACKAGES *Style* Additional items in Style standards

SALOON

- Exclusive wood color Sipo oder Teak
- Chestnut floor or optional Ocean line
- Covered elements on main bulkheads
- Companion way with modern optic

PANTRY

- High quality kitchen worktop
- 3 burner gas cook top with oven
- 160 l cooler/fridge combination
- stainless steel drawers
- Kitchen layout with additional stowage

MISCELLANEOUS

- LED ambient light with dimmer function
- High quality worktop in each Bathroom- white
- Rope bags at halyard winches

STANDARD EQUIPMENT*

Exterior

Hull/Rudder/Keel

Hull colour white, Coloured stripe on hull, grey 8 hull windows (fixed)

Cast iron keel as deep keel, Emergency tiller, Rudder

Steering

2 steering pedestals and steering wheels covered with leather

Helm'sman seat, Compass on cockpit table

Sailing Equipment

Sport rig, Backstay adjuster, Windex, 2 winch handles

Mainsail in dacron, offshore-quality, for sport rig

Furling jib in dacron, offshore-quality, UV-protection

Deck/Cockpit

1 Deck ventilator, Twin mainsheet system

Cockpit floor, Pulpit, pushpit, Bow fitting with anchor roller

Side deck and coach roof with non slip structure

6 Aluminium cleats, Guardrail opening on both sides

Electric windlass incl. remote control

Cockpit table with foldable wings and storage box

Box for gas bottles, self drained,

Teak on cockpit seats

Cockpit-shower with cold and warm water

Bathing platform

Bathing ladder stainless steel

Bathing platform manually lowerable with teak

Cockpit-shower cold and warm water

Winches

2 x Lewmar Evo aluminium halyard winches,

1-gear, self-tailing (45), 2-gear, self-tailing (50)

2 x Lewmar Evo aluminium genoa winches

Interior

Cabins

3 cabins

Cabinet in foreship and aft cabin

Mattresses fabric „Living“

Saloon

Interior in solid wood and veneer, standard in mahogany

Saloon table

Artificial leather covered headlining panels

Saloon with settee incl. relax edges

Sideboards, shelves and cabinets

Handholds in saloon and at companion way

Storage space with drawers and flaps

Upholstery „Comfort“ with relax edges

(color selection brown, blue, creme)

Companion way door with perspex-insert

Blinds on hatches, Mosquito screen on hatches

Galley

2 burner gas cook top with oven

Cooler with compressor 147liter (2C-optional)

Fridge with compressor 110liter

(only 2C Version)

Double stainless steel sink

Bathroom

Pump-toilet, large ø 38 cm with holding tank

disposal via seacock and deck suction for each toilet

Shower in aft Bathroom with shower room

separation port

Shower in foreship (only 3C-version)

Hatches and side windows

8 openable hatches, 6 openable port lights

Systems

Fresh water

Electric pressurised water pump with filter

Warm water boiler 40 l operated via

engine-cooling

circuit and shore power

Bilge pump

Manual bilge pump, Electric bilge pump

Engine

Two circuit cooling with seawater filter

Engine hour meter and rev meter, Fuel

indicator

Electric System

2 separated battery circuits for engine and service

Main power supply with circuit breaker and

control lamps

AC-outlet package (1 per cabin and 3 in galley)

12 V outlet at switch board, 3 AGM board

batteries, 92 Ah

Shore power 230 V

(shore power 110 V as an option)

Battery charger, 40 A (3-channel),

2 USB Outlets

12 V outlet at switch board

Navigation

Chart table with instrument console

Navigation lights (LED), deck light

Chart table seat

Miscellaneous

3 Fire extinguishers

Certification

CE-Certification category A and B

GL CE-Yacht certification

* INKLUSIVE ENHANCED STANDARDS