

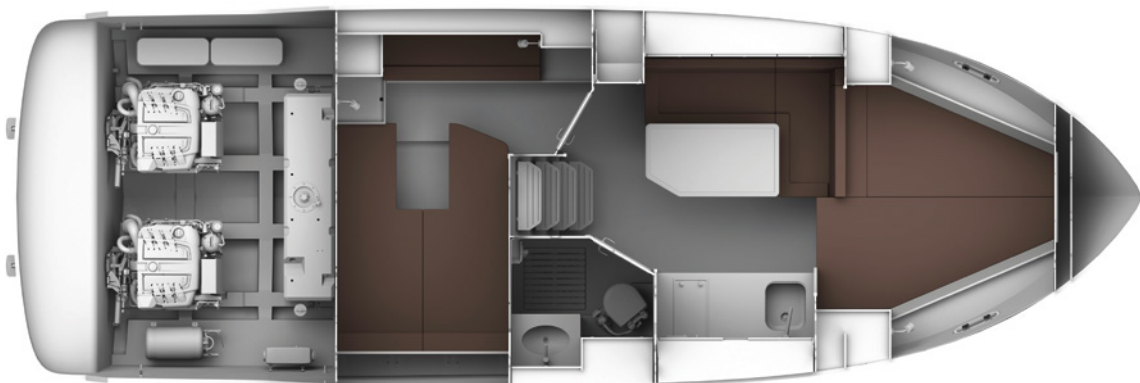

Layout Deck



1-Cabin Version



Technical data

Length overall	10,06 m
Length overall incl. Bathing platform	10,97 m
Length hull	9,61 m
Beam overall	3,31 m
Height above waterline	3,07 m
Draught, drive raised (approx.)	0,75 m
Draught, drive lowered (approx.)	1,23 m
Dry weight from (approx.)	6.000 kg
Fuel tank (approx.)	520 l
Water tank (approx.)	150 l
People, max. CE B	8
Cabins – Bathroom	1 – 1
Berths	4
Height in cabin (approx.)	1,90 m

Motorisations optional (prices with standard equipment, ex transport, ex VAT)

Axius Premium Joystick (only Mercruiser twin engines)	9.900,00
Volvo Penta Gasoline Engines	
2 x V6-240-CE 4.3L (2 x 243 PS/mhp, 2 x 179kW)	132.000,00
1 x V8-350-CE 5.3L (1 x 355 PS/mhp, 1 x 261kW)	121.700,00
2 x V8-300-CE 5.3L (2 x 305 PS/mhp, 2 x 224 kW)	148.000,00
Volvo Penta Diesel Engines	
1 x D6-370 EVC (1 x 370 PS/mhp, 1 x 272kW)	138.800,00
2 x D3-170 EVC (2 x 170 PS/mhp, 2 x 125 kW)	146.200,00
2 x D3-220 EVC (2 x 220 PS/mhp, 2 x 162 kW)	
(only in combination with electric Bennett Trim Tabs)	146.200,00
Aquamatic Joystick (only Volvo Penta twin engines)	11.400,00

List price ex works (excl. VAT.)

123.000,00 EUR

Standard motorisation Mercruiser Gasoline 2 x 4.5L -250- DTS (2 x 253 PS/mph, 2 x 186 kW)

YOUR BENEFIT: THE BAVARIA ENHANCED STANDARD



EXTERIOR

- Radar arch, grey GRP, incl. overhead lighting (OP)
- Transom-Shower for hot and cold water
- Grey tinted side windows (safety glass)

INTERIOR

- Blinds and mosquito screen to hatches
- Water heater 20l operated
- Large bowl pump-toilet with holding tank (disposal via seacock and deck suction)

SYSTEMS

- Powertrim assistant (only Gasoline engines)
- Battery charger, 40 A (3-channel)
- Board battery 2 x 140 Ah

STANDARD EQUIPMENT

EXTERIOR

Steering

Height adjustable sport steering wheel

Hull

6 opening portlights (with blinds)

Dark grey coloured stripe on hull,

6 stainless steel cleats

Deck

4 opening hatches,

1 opening cockpit window

Anchor locker, self-drained, Stainless steel pulpit

Stainless steel handrails and handrail at radar arch

Bathing platform

Bathing platform integrated with bathing ladder (telescope)

Cockpit

Wetbar with sink and cover, Cockpit, self-drained

Cockpit light integrated in radar arch

Clear Windscreen (security glass), Cockpit table

Illuminated compass, Helmstand with single seat

Settee and sunpad with upholstery, Cockpit upholstery

Sliding companionway door, grey tinted safety glass

Copilot seat on portside, flipable

Windscreen wiper, stb.

Manually lowerable cockpit table incl. upholstery

Cupholder stainless steel in cockpit

Anchor

Stainless steel bow fitting with anchor roller

INTERIOR

Cabins

Double berth in separate aft cabin,

Mattress fabric "Living"

Interior in solid wood and veneer,

Upholstery „Comfort“

standard in mahogany and chestnut floor

Saloon

Reading lights, LED-downlights, Settee in saloon

Saloon table, skylight window in deck

Stowage space

Lockers and shelving, Stowage space

Stowage space under seating area and aft sun pad

Overhead lockers and wardrobe

Galley

Ceramic cook top, Refrigerator, 12 V, 50 liters

Stainless steel sink, with cover

Water system

Electric pressurized water pump with filter

SYSTEMS

Safety

CE-fire extinguishing system; 2 fire extinguishers

Navigation

Navigation lights (BSH certification), Signal horn

Speed depth, Bidata

Engine compartment

Electric engine bay cover, Engine bay fan

Electric bilge pump in aft cabin

Instrumentation

Analogue instrumentation: speed, engine temp., engine counter, voltmeter, rev tachometer, fuel-gauge, Trim display

Digital multi-functional display giving trip information, current and average fuel consumption plus engine information

Drive

Z-Drive with hydraulic steering

EVC electronic throttles for Volvo Penta twin and single engines

Bravo III electronic throttles for Mercruiser twin engines with cruise control and single lever

Bravo III electronic throttles for Mercruiser single engine with cruise control

Electric system

AC-outlets (1 in cabin and 1 in galley)

Shore power, 230 V, Starter battery (1 x per engine)

Main switch for board batteries and starter battery

Certificate

CE-Certification category B, C

GL CE-Yacht certification